

FGA BATTERY INSTALLATION INSTRUCTIONS

Rev 1.0 (6/10/2021)

FGA Battery Kit

The FGA battery kit (# 076606) comes with the battery soldered to the PCB assembly. *Do not remove the battery from the board.*

Battery



Removal Process

1. Use a 1.5mm hex key to remove the screw.
2. Remove cover.
3. Remove the old PCB assembly.

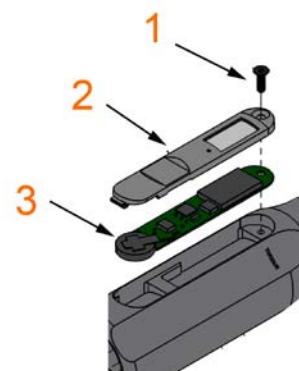

Installation Process

1. Remove the clear protective cover from the LCD screen.
2. Place the new PCB assembly in the handle.
 - a. Make sure the board lever catches the slot on the upper perch (indicated by the orange arrow in the image to the right).
 - b. You may use the adjustment knob to verify the installation is correct – when the board is powered on and held in place, the display value should change when turning the adjustment knob.
3. Place the cover over the board by first catching the tongue on the cover in the groove on the handle (next to the battery).
4. Apply Loctite® 425™ to the screw. Use a 1.5mm hex key to tighten the screw to 4 lbf-in. Allow a minimum of 20 minutes for Loctite to cure.

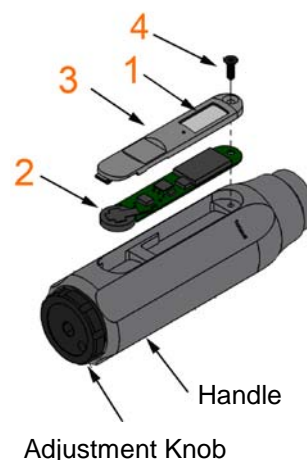
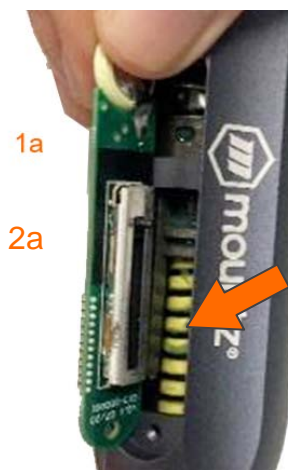

Calibration

The screwdriver needs to be recalibrated after the battery kit installation.