

Distributed by: ABQ Industrial LP USA
Tel: +1 (281) 516-9292 / (888) 275-5772 **eFax:** +1 (866) 234-0451
Web: <https://www.abqindustrial.net> **E-mail:** info@abqindustrial.net

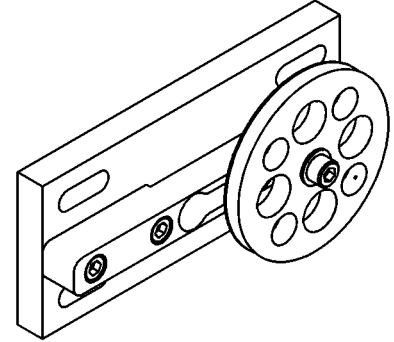

Typical Transducer Specifications

- *Tension Range: Supplied to Customer's requirements.
- *Contact Elements: To fit application.
- *Operating Temperature: 70' ± 25' F. (Special ranges available)
- *Connecting Terminals: 5 pin Amphenol plug or terminated ends.
- *Excitation Voltage: 4-10 VDC.
- *Bridge Resistance: 350 ohms nominal.
- *Output Signal: 1.0 - 2.0 mv/V nominal.
- *Resistance to Ground: Exceeding 500 Megaohms.
- *Zero Balance: Less than 1.5% FS
- *Drift at Midpoint: 0.2%
- *Noise Level: Less than 0.2%
- *Linearity: 0.5%
- *Combined Linearity & Hysteresis: ± .75%
- *Total Error: 1% FS
- *Overload Tension: 50% Overated
- *Shielded Cable: 10' standard length.



		Revision History		
Zone	Rev.	Description	Date	Approval
N/A	2	REMODELED AND REDRAWN	7-16-147	M. BROCKMAN

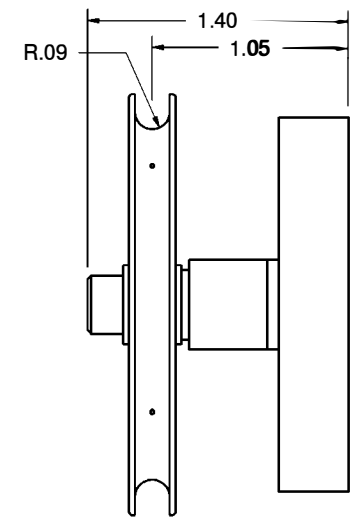
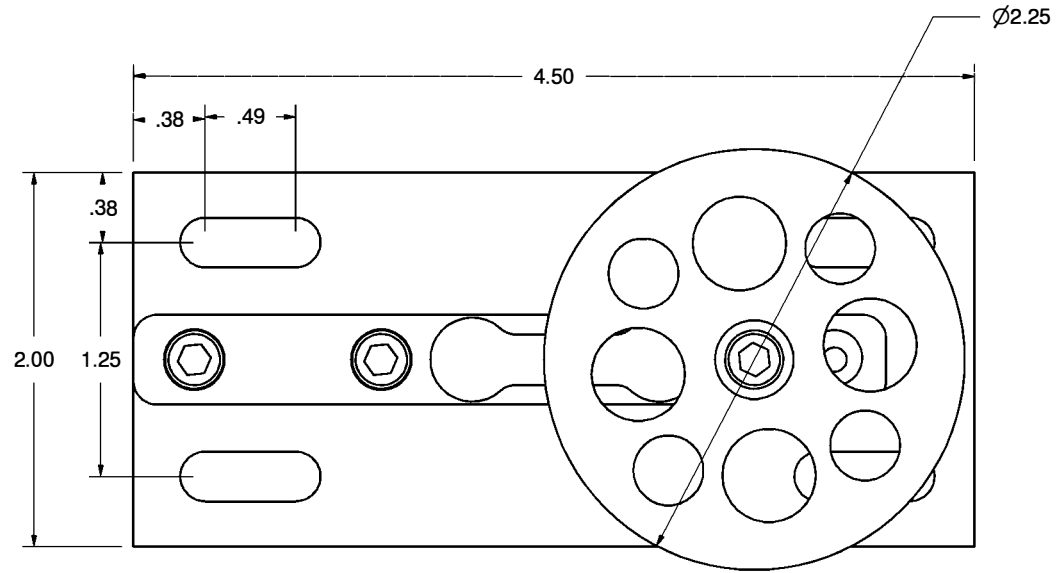

Application Note:

Roller configuration adjustable to meet specific applications. For optimum accuracy evenly guide material over pulley with a minimum wrap angle of 12°. For best accuracy keep wrap angle as consistent as possible.

Material ALUMINUM		Finish CLEAR ANODIZE		Heat Treat	
DIMENSIONAL TOLERANCES UNLESS OTHERWISE SPECIFIED		TITLE SENSING BEAM CONFIGURED WITH MOUNTING PLATFORM		Weight	
.XXX	.XXX	.XX	ANGLE		
± .0005	± .005	± .01	± 1°		
Scale 1:1	No. Req'd	Drawn SHS	Date 6-22-07	Size	Drawing Number
Next Assy		Checked	Date		
		Approved	Date		
					REV
					FT-117
					2