

LAQUA

Quick Manual

pH Meter F-72,73,74

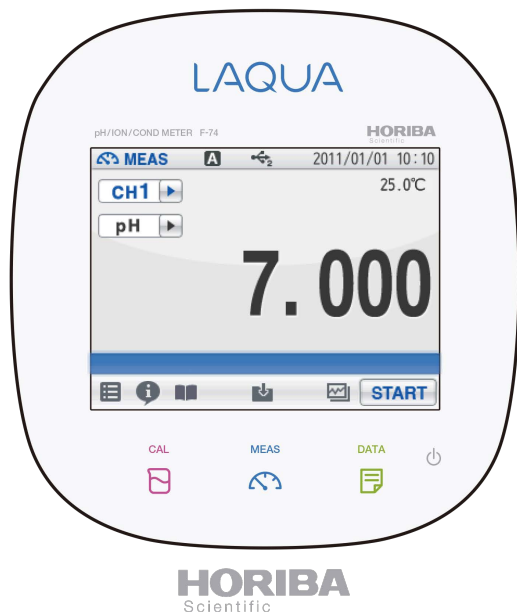

CODE : GZ0000272694B

January, 2017 © 2017 HORIBA Advanced Techno Co., Ltd.

Preparation

① Prepare pH standard solutions



② Connect the electrode to the pH meter



③ Press the power button of the pH meter

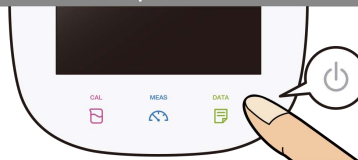

☆ Press the power button for 2 seconds.

※ Wait for 10 seconds after connecting the AC adapter before pressing the power button.

④ Remove the protective cap from the electrode, and open the internal solution filler port

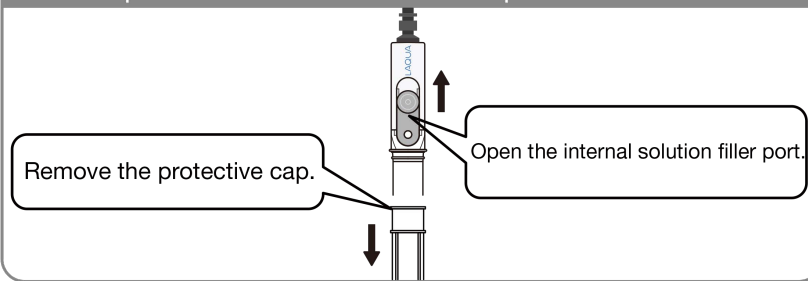

Calibration

When the measurement sample is known to be acid, perform two-point calibration with pH7 and pH4.
 When it is known to be alkaline, perform two-point calibration with pH7 and pH9.
 When the sample pH is not known, perform three-point calibration with pH4, pH7 and pH9.

① Enter the calibration mode

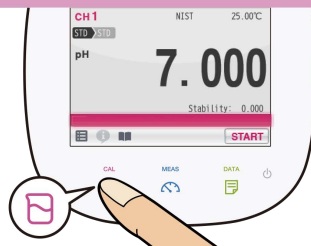

② Start the first point calibration

Immerse the electrode in the pH7 standard solution until the liquid junction part is fully submerged.



Confirm that the instantaneous value is stable, then press **START** button.

When the **Hold** indication changes from the blinking state to the lit state, calibration is complete.



To second point calibration with **STOP** button.

③ Start the second point calibration

Immerse the electrode in the pH4 standard solution until the liquid junction part is fully submerged.



Confirm that the instantaneous value is stable, then press **START** button.

When the **Hold** indication changes from the blinking state to the lit state, calibration is complete.

To measurement

or

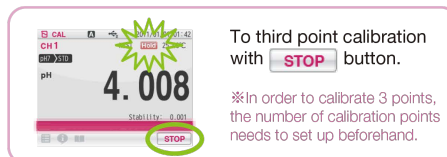

To third point calibration with **STOP** button.
 ※In order to calibrate 3 points, the number of calibration points needs to set up beforehand.

④ Start the third point calibration

Immerse the electrode in the pH9 standard solution until the liquid junction part is fully submerged.



※The calibration method is the same as first and second point calibration.

To measurement

Measurement

① Enter the measurement mode



② Start the measurement

Immerse the electrode in the sample until the liquid junction part is fully submerged.

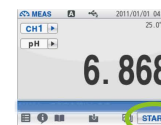

Confirm that the instantaneous value is stable, then press **START** button.

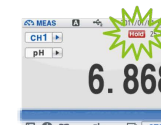

When the **Hold** indication changes from the blinking state to the lit state, measurement is complete.